

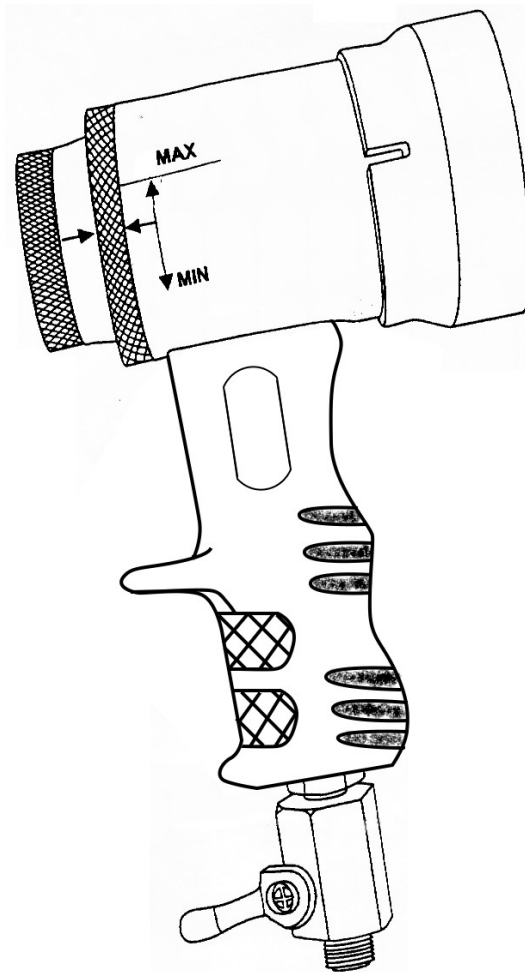

ATD-16800

PROFESSIONAL AIR DRYER GUN



Specifications:

Air Consumption: 12 CFM (350 L/min)
Air Pressure: 58 to 65 PSI (4 to 4.5 bar)
Max. Air Pressure: 175 PSI (12 bar)

Application:

The ATD-16800 Professional Air Dryer Gun is used to rapidly dry applied water and solvent based paint and is especially useful for drying small painted areas.

How to operate:

- (1) With air valve closed, connect air hose to air inlet.
- (2) Set incoming air pressure between 58 to 65 PSI (4 to 4.5 BAR).
- (3) Adjust Nozzle to full closed position.
- (4) Turn on the air valve.
- (5) Loosen the lock nut then loosen the adjustable nozzle to adjust airflow.
- (6) The airflow is adjustable by turning the adjustable nozzle anywhere between MIN and MAX.
- (7) When setting the airflow do not go over the MAX setting, this may cause turbulence.
- (8) Hand-tighten lock nut to secure adjustable nozzle.

Handling:

Keep the ATD 16800 Professional Air Dryer Gun at least 10-20 inches (30-50cm) away from the applied paints or coatings.

CAUTION!

Do not use ATD 16800 Professional Air Dryer Gun on paints that contain silicon or on a "hammer finish". The use may cause silicon craters.

DO NOT USE THIS PRODUCT IN HAZARDOUS AREAS.

ATD-16800

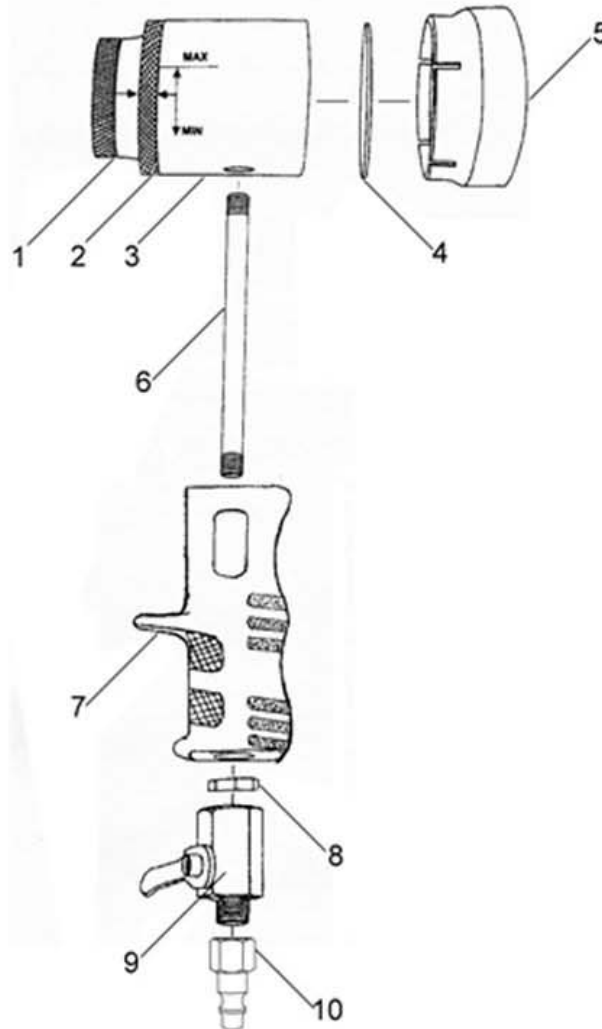

ITEM#	ORDERING PART#	PART DESCRIPTION
1	PRT16800-01-03	ADJUSTABLE NOZZLE, LOCK NUT & BODY
2	PRT16800-01-03	ADJUSTABLE NOZZLE, LOCK NUT & BODY
3	PRT16800-01-03	ADJUSTABLE NOZZLE, LOCK NUT & BODY
4	PRT16800-04	FILTER
5	PRT16800-05	DIFFUSER
6	PRT16800-06	AIR TUBE
7	PRT16800-07	HANDLE
8	PRT16800-08	RETAINING NUT
9	PRT16800-09	SHUT OFF VALVE
10	PRT16800-10	AIR NIPPLE